

# VetFlo™

Traditional vaporizer



VetFlo vaporizer with single channel anesthesia stand



VetFlo vaporizer with four channel anesthesia stand

#### Features & Benefits:

- Brand new vaporizer  
*Never reconditioned or remanufactured*
- Superior design  
*Durable stand; accurate, high-quality flowmeter; small footprint*
- Complete system  
*Includes tubing and connectors*
- Multi animal capability  
*2, 4 and 6-channel models*

1-Year 100% Parts & Labor Warranty

Order your VetFlo:  
**888.572.8887**



**Kent Scientific**  
CORPORATION

## VetFlo Vaporizer

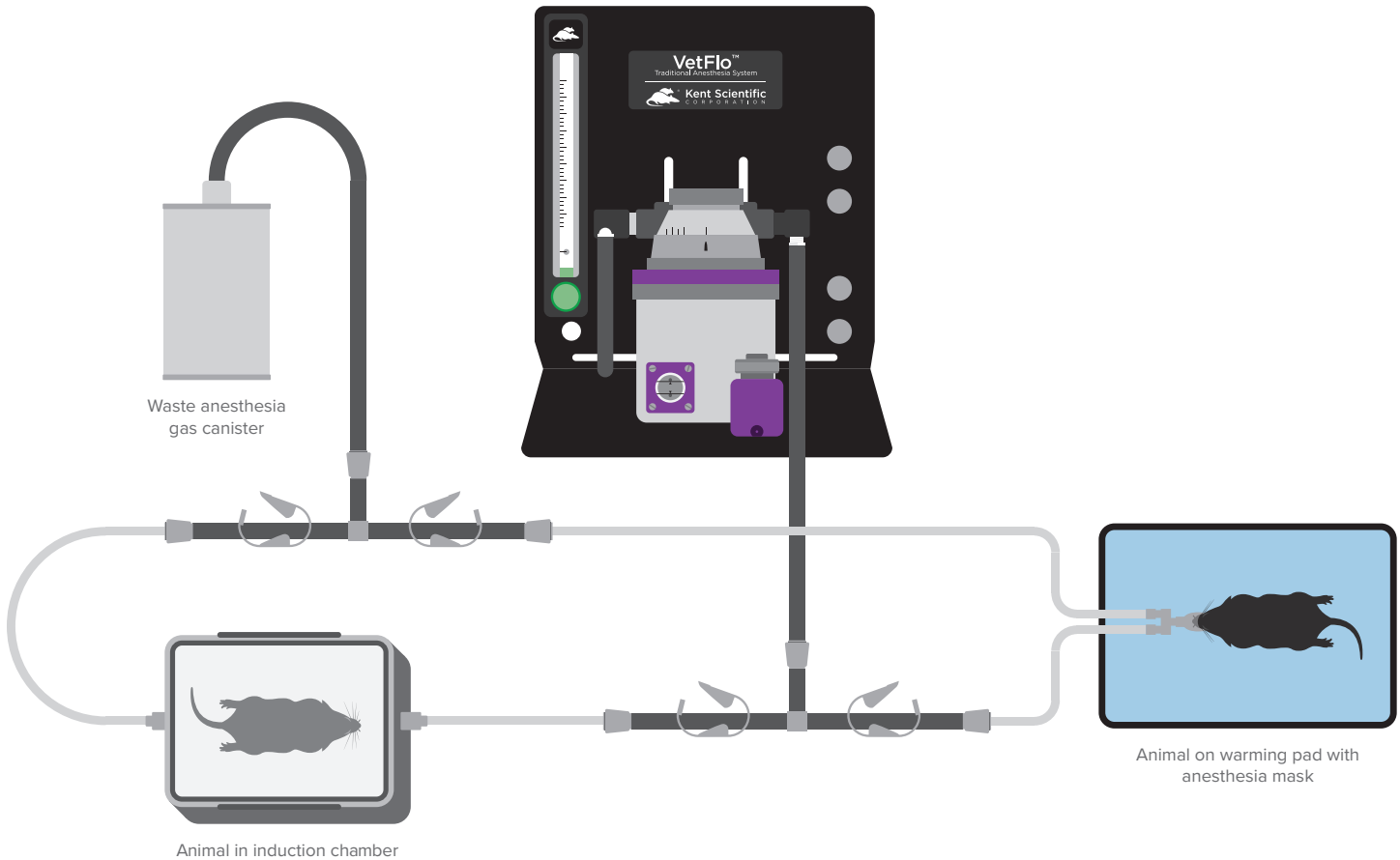

Perfect for laboratory and veterinary anesthesia delivery, the VetFlo vaporizer is completely self contained and portable. The multi-channel base is designed for multiple stations that are individually controlled. You can work with up to six stations, operating off of one vaporizer. With an easy-to-follow chart, each station can deliver a different flow rate of anesthesia.

For your safety, the safety of your animals and the integrity of your study, Kent Scientific offers genuine, new vaporizers manufactured specifically for either isoflurane or sevoflurane.

### VetFlo traditional vaporizer includes:

- Tabletop stand
- One inlet flowmeter, 0 to 1000 mL (200 to 4000 mL flowmeters are available, except on 6-channel systems)
- Multi-channel system has two, four or six outlet flowmeters (depending on # of channels)
- One set of inlet/outlet caps
- Charcoal filter canister
- High pressure oxygen hose with DISS fittings

1-Year 100% Parts & Labor Warranty

Order your VetFlo:  
**888.572.8887**  
kentscientific.com



**Kent Scientific**  
CORPORATION