

SomnoPath® Flow Diverter



Colored Indicator Lights

Easily identify the active line

Inspiratory Anesthesia Gas & Expiratory Waste Anesthesia Ports

Attach directional tubing

Dual Delivery Paths

Simple push-button select for flow destination to intubation chamber, face mask or other accessory

Inlet/Exhaust

Anesthesia inlet and WAG exhaust ports

Features & Benefits:

- **Easy push-button interface**
Controls anesthesia delivery to two different destinations
- **No manual tubing clamps or hardware**
Simplifies anesthesia delivery and maintenance
- **Adaptable design**
Works with any low-flow or traditional anesthesia delivery system

Order your SomnoPath:

888.572.8887



Kent Scientific
CORPORATION

What is SomnoPath?

The SomnoPath is an easy-to-use anesthetic flow diverter. Use the SomnoPath to direct anesthetic gas to your induction chamber, nose cone, stereotaxic system, or other anesthetic accessories with the touch of a button.

The SomnoPath allows you to connect up to two accessories and direct flow to either Line 1 or Line 2.

Specifications:

Dimensions:	7.0 in x 7.0 in x 2.5 in (17.8 cm x 17.8 cm x 6.4 cm)
Voltage:	Max Inlet Pressure 12V, 2.5A
Max Inlet Pressure:	15 PSI
Recommended Flow Rates:	0-5LPM
Environmental:	Intended for Indoor Use Only
Optimal Operating Temperature:	18°C - 26°C (26°C Max)
Relative Humidity:	up to 90%
Altitude:	0 - 2,000 meters
Overvoltage Category:	II

1-Year 100% Parts & Labor Warranty

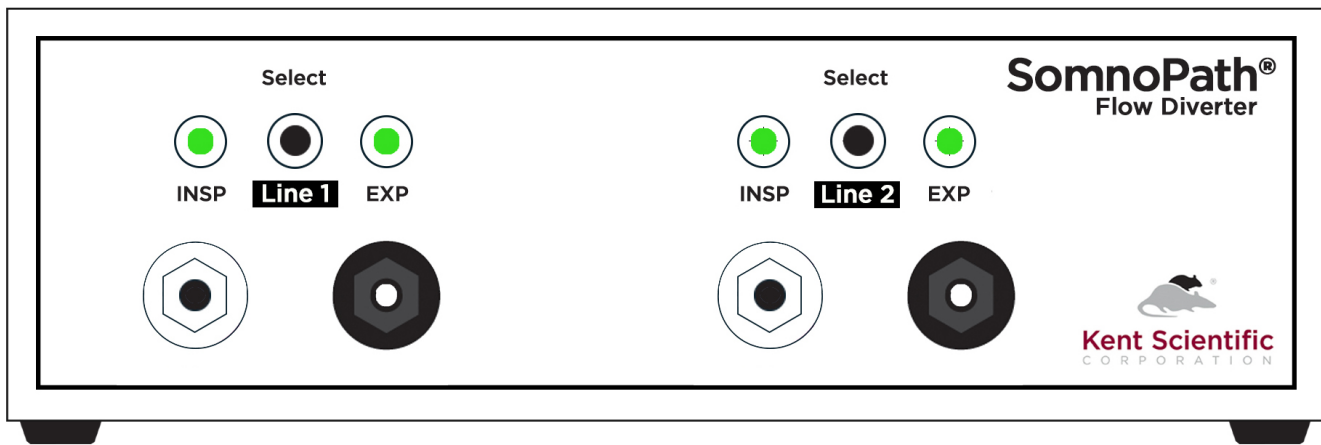

Front View

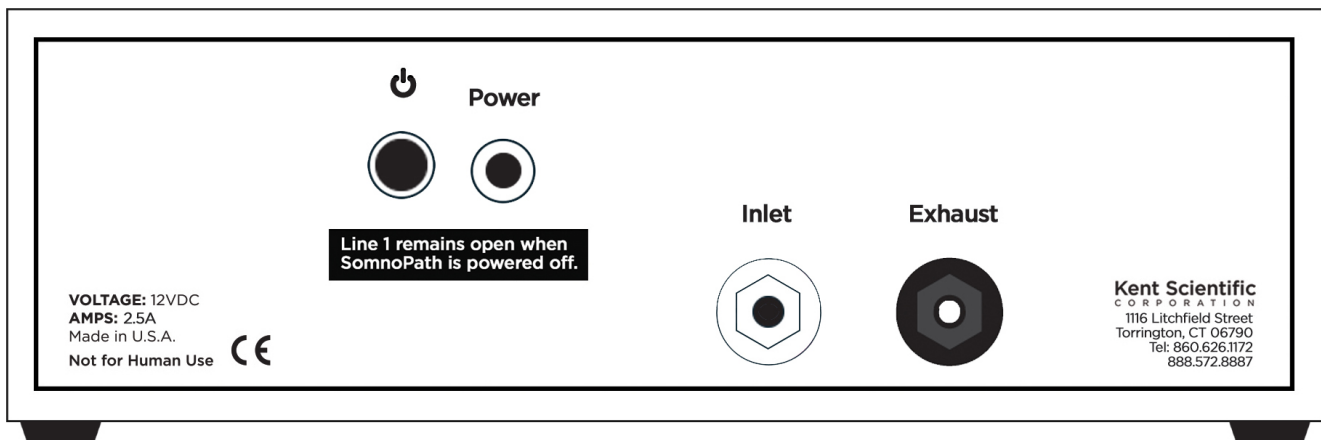

Side View

Order your SomnoPath today:

888.572.8887

kentscientific.com



Kent Scientific
CORPORATION

01.23.1